

No.	Revision/Issue	Date	By
6	12" brackets, flat stock	4/21	CH

**STANDARD  
DRAWING  
TSD5\_18**

**ROADSIDE SIGN  
INSTALLATION DETAIL**

City of Springfield  
SPRINGFIELD OREGON



EXP DATE: 12-31-2021

**May 5, 2021**

**NOT TO SCALE**

DRAWN BY: C. HANSEN  
DESIGNED BY: M. LIEBLER  
CHECKED BY: B. BARNETT

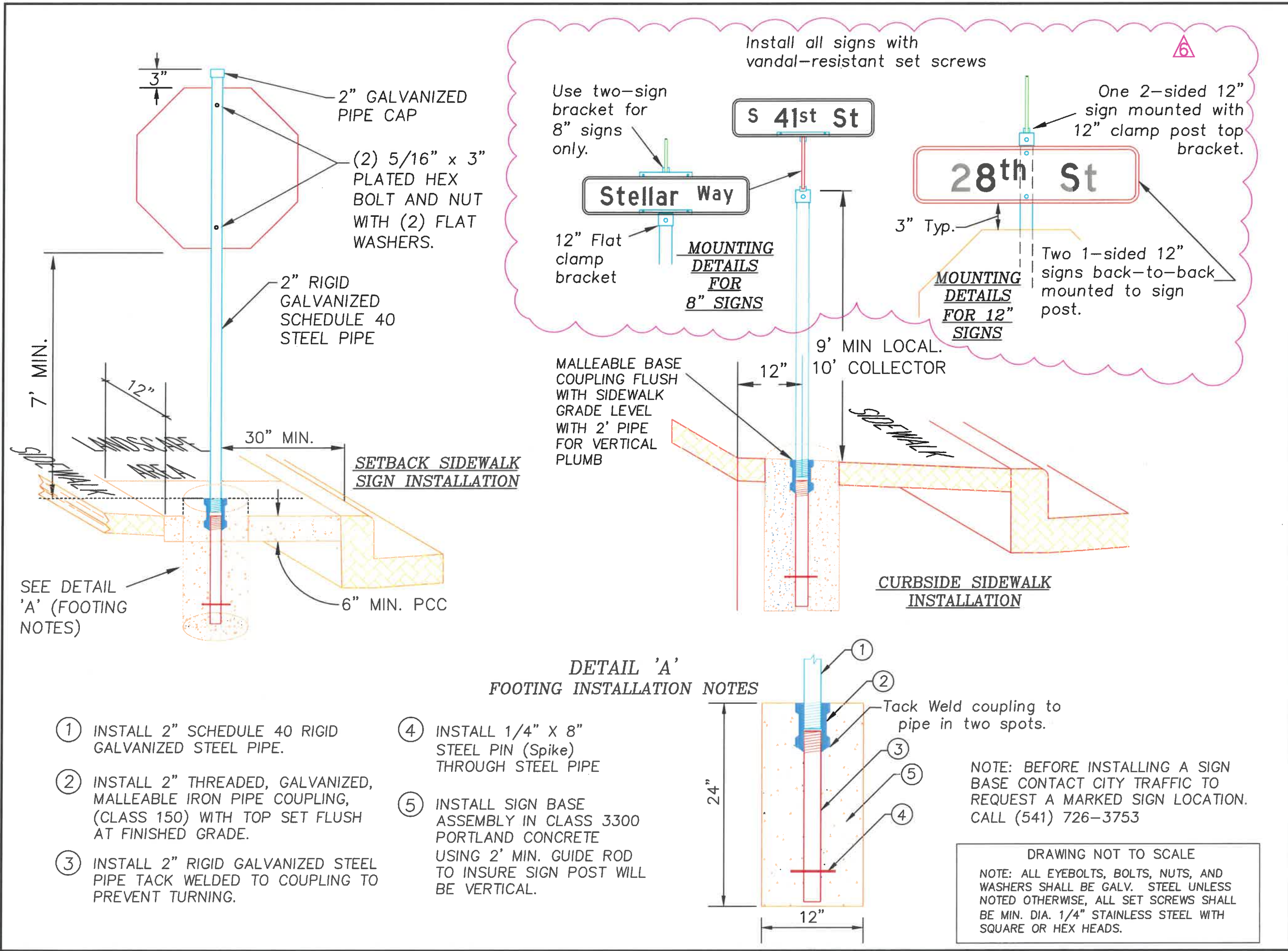

**DETAIL 'A'  
FOOTING INSTALLATION NOTES**

- ① INSTALL 2" SCHEDULE 40 RIGID GALVANIZED STEEL PIPE.
- ② INSTALL 2" THREADED, GALVANIZED, MALLEABLE IRON PIPE COUPLING, (CLASS 150) WITH TOP SET FLUSH AT FINISHED GRADE.
- ③ INSTALL 2" RIGID GALVANIZED STEEL PIPE TACK WELDED TO COUPLING TO PREVENT TURNING.
- ④ INSTALL 1/4" X 8" STEEL PIN (Spike) THROUGH STEEL PIPE
- ⑤ INSTALL SIGN BASE ASSEMBLY IN CLASS 3300 PORTLAND CONCRETE USING 2' MIN. GUIDE ROD TO INSURE SIGN POST WILL BE VERTICAL.

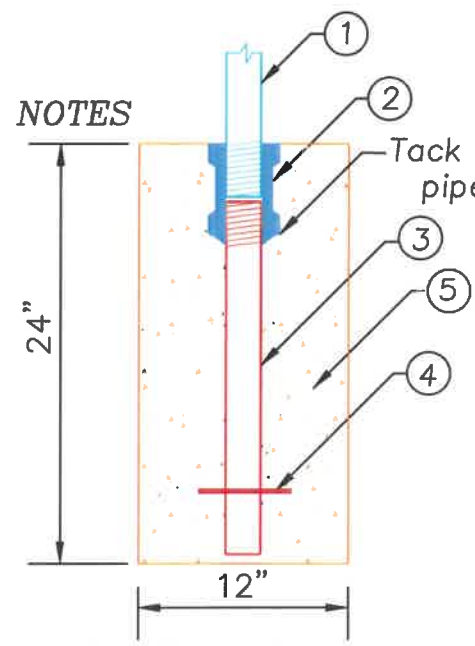

NOTE: BEFORE INSTALLING A SIGN BASE CONTACT CITY TRAFFIC TO REQUEST A MARKED SIGN LOCATION. CALL (541) 726-3753

DRAWING NOT TO SCALE  
NOTE: ALL EYEBOLTS, BOLTS, NUTS, AND WASHERS SHALL BE GALV. STEEL UNLESS NOTED OTHERWISE, ALL SET SCREWS SHALL BE MIN. DIA. 1/4" STAINLESS STEEL WITH SQUARE OR HEX HEADS.